



ENGLISH

Instructions for Use

Read and observe the following information and keep the instructions for use for future reference!

WARNING!

Safety indications

- Explosion hazard!
- Use only the mains power supplies supplied!
- Use only rechargeable batteries supplied or equivalent!
- Always treat batteries and rechargeable batteries with caution and use batteries and rechargeable batteries only as described.
- Never mix rechargeable batteries with batteries.
- Never use rechargeable batteries or batteries with different capacities or states of charge.
- Avoid using defective rechargeable batteries or batteries.
- Death hazard for pacemaker users!
- Maintain a safety distance of at least 15 cm from pacemaker users.
- Choking hazard due to small parts, protective films and packaging!
- Keep this packaging out of the reach of children!
- Rechargeable batteries and batteries can cause damage to health and the environment!
- Do not open, damage, swallow or disperse accumulators and batteries in the environment. These can contain heavy metals harmful and damaging for the environment.

ATTENTION!

- Risk of material damage.
- Avoid exposure to smoke, dust, vibrations, chemicals,
- humidity, heat and direct sunlight.
- Repairs should only be entrusted to qualified personnel from the technical assistance service.

Note that some services of your mobile phone may need to be activated by this provider before you can use it.

USE ACCORDING TO THE INTENDED USE

This mobile phone allows you to make phone calls and send SMS. Any other use is considered improper. Observe local laws and regulations. Unauthorized modifications or changes are not allowed. Do not open the appliance for any reason, nor carry out repairs on your own initiative.

OBJECT SUPPLIED

- 1 mobile phone, 1 rechargeable lithium-ion battery, 1 user manual, 1 charging cradle

Charge the rechargeable battery

Charge the rechargeable battery for the first time for at least 12 hours, then fully charge and discharge it for a few cycles. This prolongs the useful life of the rechargeable battery. Place the portable unit in the charging station.

COMMISSIONING

- Insert SIM card and rechargeable battery
- The SIM card can be damaged.
- Be careful to keep the SIM card clean and intact. Insert the SIM card from the correct side.
- The rechargeable battery or phone can be damaged.
- Make sure that the rechargeable battery is inserted correctly.

Switch the phone off before removing the battery compartment cover. Switch the device on again only after having installed the battery compartment cover. Remove the battery compartment cover, insert the SIM card Insert the battery, install the battery compartment cover

1	Left menu key / Main menu
2	Green Call key / Call logs To access the call log from standby
3	M1 one-touch key
4	Key * Press this key in standby mode to access the following characters: */+P/W.
5	Speaker
6	Direction button (up) In standby mode, access the SMS menu;
7	Direction button (down) In standby mode, access to photos contacts
8	Right menu key / In standby mode, access the directory
9	Turn the phone on or off, end a call, reject a call
10	M2 one-touch key
11	Camera key
12	Hash # key Press and hold in standby mode to enable/disable the silent mode. In writing mode, it allows you to change the input method.
13	Emergency call button
14	Polyphonic speakers
15	Headphone input (3.5 mm)
16	USB Type-C charging port
17	Volume up (+) key
18	Flashlight Press and hold the volume up key 17 or volume down key 19 key to turn the flashlight on/off
19	Volume down (-) key

Insert the SIM/microSD card

The phone must be turned off and disconnected from the charger. To remove the battery compartment cover from the back, press with the thumb nail on the bottom left of the cover.

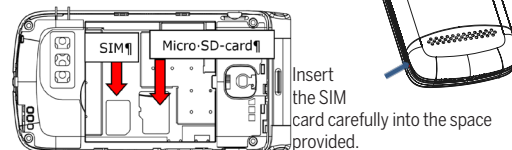

Charge the rechargeable battery

There are two options for charging the battery:
A. Charging base
B. Battery charger
1. Insert the charger connector into the phone.
2. Connect the charger to a power outlet.

SET THE DISPLAY LANGUAGE

<Menu> --> <Settings> OK
<Phone settings> OK <Language> OK
[Choose a language] OK

Call/Dial

[Insert the phone number] [Call] The number is

Answer a call [Call]

End a call [Call]

Redial from the call list

[Call] --> [Select an entry] [Call]

STRUCTURE AND FUNCTIONS MENU

PHONE CONTACTS

<Menu> --> <Contacts> OK
• Press <Options> to access the following functions:
• Phonebook • New Contact • Photo contacts • Speed dial
• M1/M2 (I/II) Quick Dial • Delete • Delete multiple • Add to blacklist • Others

MESSAGES

<Menu> --> <Messages> OK
• Write message • Inbox • Outbox • Drafts • Sent • Quick response
• Voicemail

To access the options, press the camera button.

The following functions are available:

- Open • Settings • Delete all • Message capacity

CALL LIST

<Menu> --> <Call log> OK
• All calls • Missed calls • Dialed calls • Received calls
• Rejected calls • Delete all • Call timers • Data Service counter

ORGANIZER

<Menu> --> <Organizer> OK
• Alarm • Calendar • Memo • Calculator • Bluetooth • World clock

MULTIMEDIA

<Menu> --> <Multimedia> OK
• Camera • Gallery • FM radio • File manager

SETTINGS

<Menu> --> <Settings> OK
• **User profiles (Ringtone settings)**
• **Phone settings**
• Date & Time • Language • Shortcut • Auto power on/off
• Display • Restore factory settings • Battery Management
• **SOS**
• SOS Status • SOS alarm • Set SOS number • SOS message
• SOS Message send (on/off)
• **Call settings**
• Flip to answer • Call forwarding • Call waiting • Call barring • Caller ID
• Blacklist • Others
• **Security settings**
• SIM PIN • Phone Locked • Change Phone password
(Default PIN: 0000)
• **Network settings**
• Network account • Data service • Data roaming • Network selection
• Network type • VoLTE
LED remind
• Incoming call Light • SMS Light

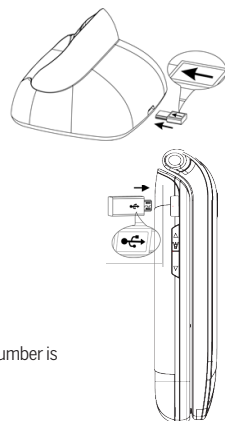

Volume control

During a phone call, use the volume up and down keys to adjust the volume.

SOS description

The SOS app is a simple function that can save human lives in critical moments. You can save all the desired contacts in the app and send them a notification via SMS.

The numbers of the SOS app, which can be saved in the desired sequence, will be automatically selected in the event of an emergency by holding down the emergency call button on the back of the phone for about 2 seconds.

Once the emergency call is activated, an alert tone audible to people nearby will sound. Then, an emergency SMS will be sent to all saved emergency numbers, if the function has been enabled.

The telephone then dials the first number saved in the SOS app; if no one answers, automatically dials the next number and so on.

The phone will try to reach the emergency contact for about 19 seconds (call confirmation tone). If the call is not answered, the phone automatically stops the operation and goes on to call the next SOS number.

This feature prevents calls from being forwarded to voicemail. In Europe, most operators expect calls to be forwarded to voicemail after about 20-25 seconds.

Declaration of conformity

Bea-fon Mobile GmbH hereby declares that the SL605LTE model complies with the essential requirements and other applicable provisions of the EU Directive (RED) 2014/53/UE. The full text of the declaration of conformity can be requested at any time. You can download a copy of the declaration of conformity from our home page at: <http://beafon.com/service/certification/>

Limitation of liability

Bea-fon Mobile GmbH will not be responsible for any indirect, special, accidental or unavoidable injuries resulting from the use of this product regardless of whether they are foreseeable or not.

The manufacturer declines any responsibility in relation to any losses caused by natural disasters (such as earthquakes, floods, etc.), or other events or accidents (such as improper, deliberate or accidental use, during these accidents or in other unusual circumstances) beyond the responsibility of the manufacturer. The commercial warranty period is 24 months from the date of purchase (for accessories, 6 months)

Further information

If you have questions or for more information about our products, you can visit our website at www.beafon.com or contact us directly. E-mail: support@beafon.com

Address

BEAFON MOBILE GmbH
4722 Peuerbach
Enzing 4
Austria

Disposal

If you no longer want to use your device, please bring it to the collection center of your municipality's waste treatment organization (e.g. recycling center). According to the law on electrical and electronic devices, owners of used devices are required to put all used electrical and electronic devices in a separate collector. The icon indicated means that you should never throw your device into household waste!



You are required by law to dispose of your batteries and rechargeable batteries at a battery dealer and at collection centers responsible for their disposal, which make suitable containers available. Their disposal is free. The icon indicated means that you should never throw batteries and rechargeable batteries into household waste, but that you must take them to a collection center. Dispose of packaging supplies in accordance with local regulations.

Technical data

Band network:	GSM: 850/900/1800/1900Mhz WCDMA:2100. LTE:B1/B3/B7/B8/B20
Battery	Lithium-ion, 3.7 V - 1050 mAh
Dimensions:	101.8 x 50.5 x 18.5 mm
Standby time:	Approximately 250 hours*
Talk time:	Approximately 350 minutes*
SAR	
Head:	0.5 W/kg
Body:	1.81 W/kg
Maximum transmission power	
GSM 900	1.58 W
GSM1800	0.79 W
UMTS 1900	0.16W
UMTS 2100	0.16W
LTE B1/3/7	0.14W/ 0.16W / 0.16W
LTE 8/20	0.18W/ 0.20W
Bluetooth	0,0025 W

*Battery life depends on SIM card, network, settings, use and environment.

ATTENTION

No charger included. Please note the crossed-out charger symbol on the packaging.

Technical Specifications for Charging

This device supports charging via USB-C cable and a USB charger compliant with local regulations and European CE safety standards.

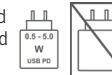

Please use only USB chargers that meet these requirements. The recommended output power is between 0.50 watts and 5.0 watts to ensure optimal charging performance. Higher output chargers are compatible but will not accelerate the charging process.

Note:

Detailed technical specifications can be found on the www.beafon.com website.

Suggestion

If the fonts are too small and difficult to read, please view a full manual version with larger fonts on our website. Visit our website and go to the Products section: www.beafon.com

Spare parts and repair information

Spare parts for this device (e.g. battery, buttons, speaker, charging port) are available for a minimum of 7 years after it has been placed on the market.

Repair manuals, spare parts, and repair information can be found on the respective product page at: www.beafon.com

We do not assume any responsibility for printing errors and any other errors. V3.6

